	
Luxury 4x4 (2006)	4.972m
Overall Length	2.034m
Overall Width	1.905m
Overall Body Height	0.279m
Min Body Ground Clearance	1.884m
Max Track Width	4.00s
Lock to lock time	5.800m
Kerb to Kerb Turning Radius	

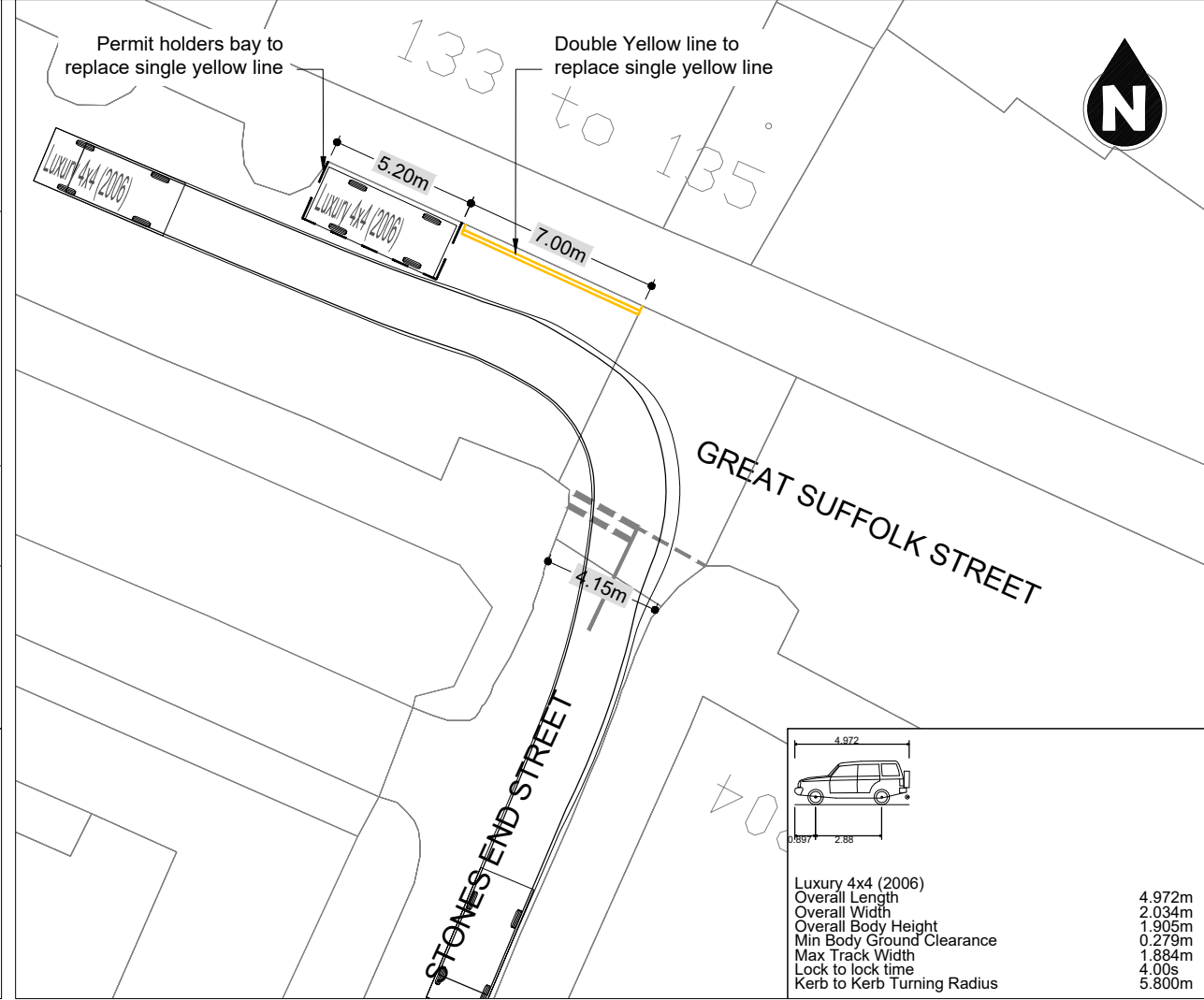

	
Luxury 4x4 (2006)	4.972m
Overall Length	2.034m
Overall Width	1.905m
Overall Body Height	0.279m
Min Body Ground Clearance	1.884m
Max Track Width	4.00s
Lock to lock time	5.800m
Kerb to Kerb Turning Radius	

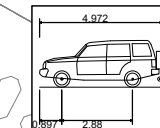

	
DB32 Refuse Vehicle	7.900m
Overall Length	2.400m
Overall Width	3.183m
Overall Body Height	0.388m
Min Body Ground Clearance	2.400m
Max Track Width	6.00s
Lock to lock time	9.625m
Kerb to Kerb Turning Radius	

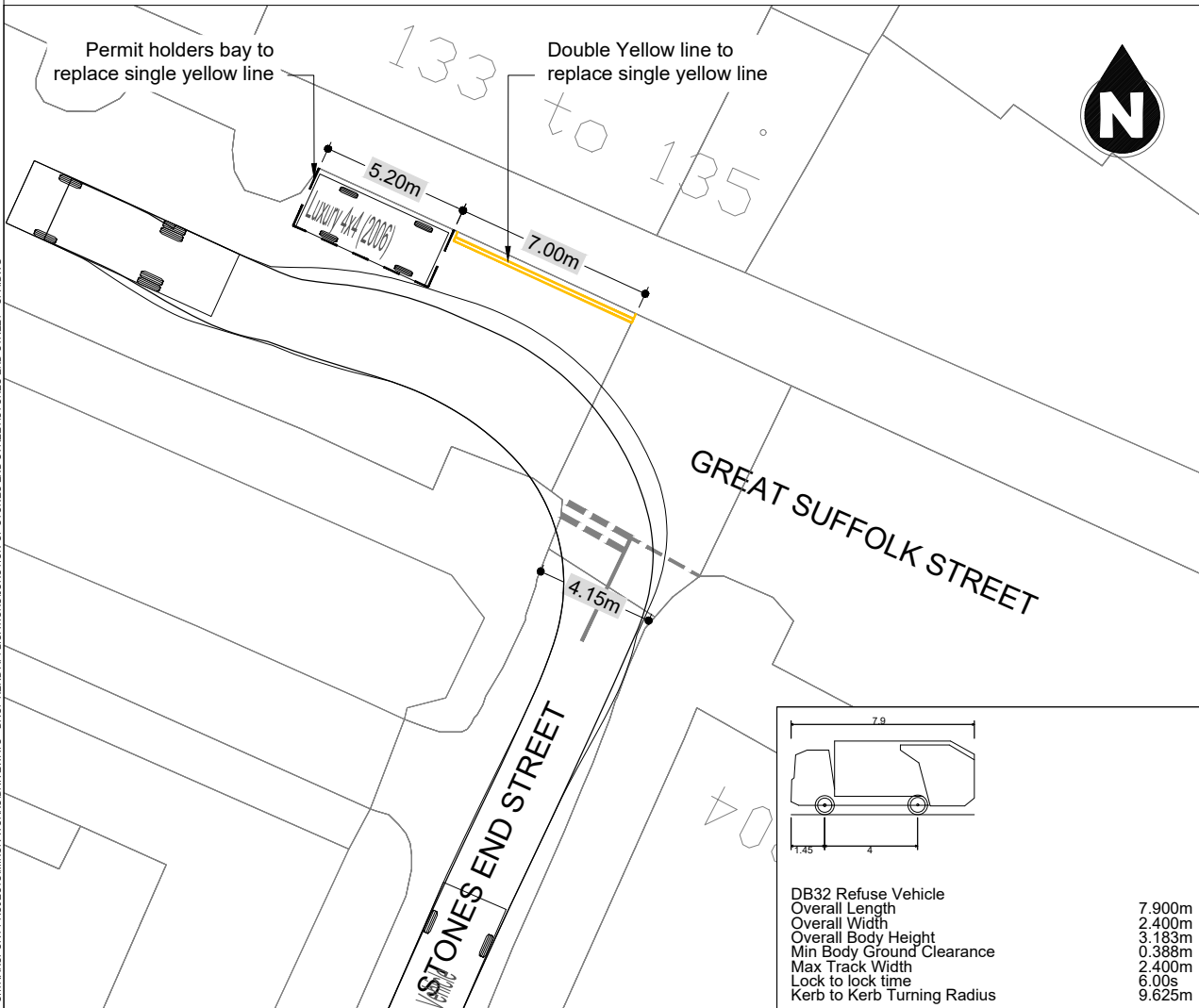
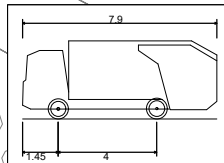
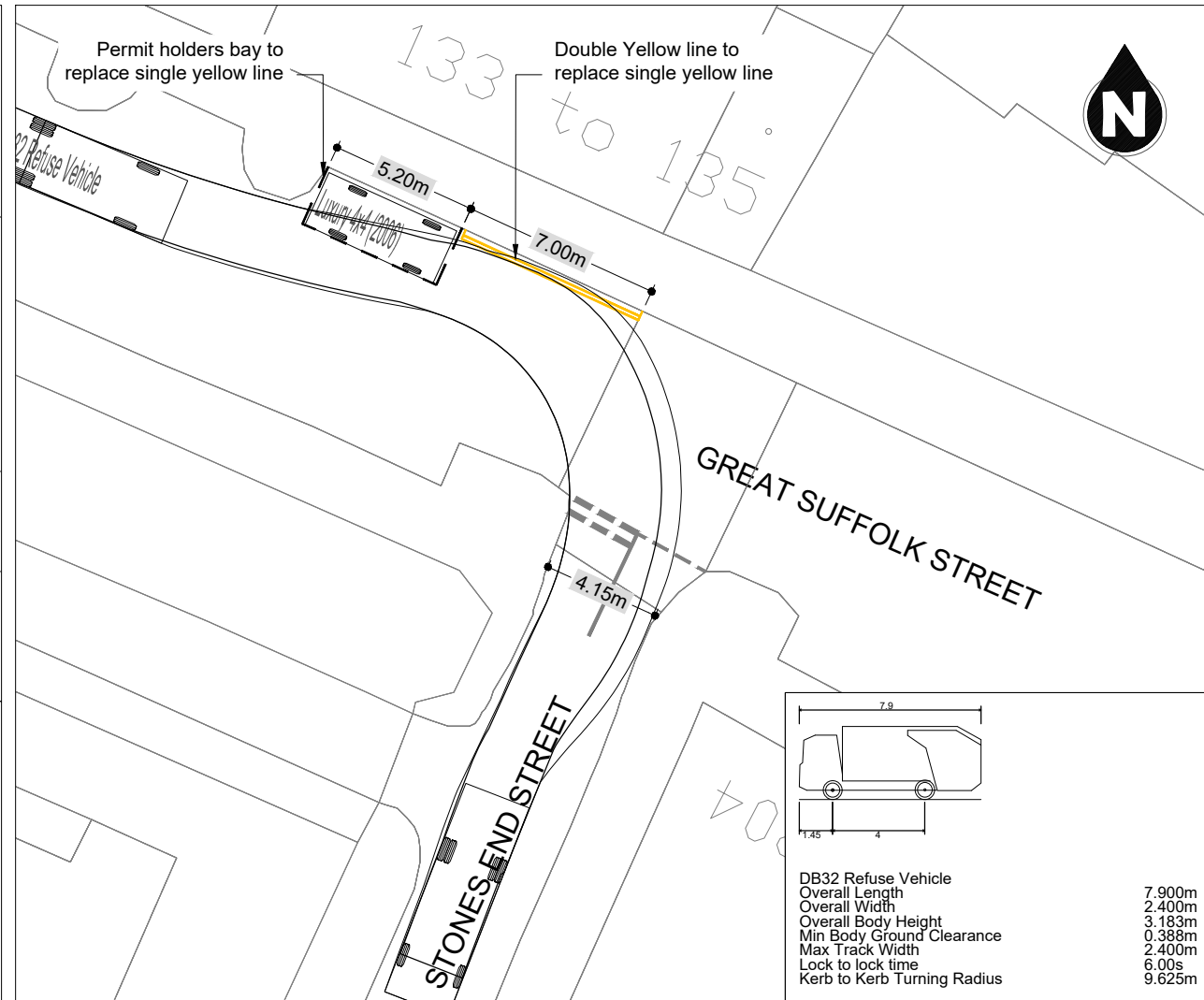

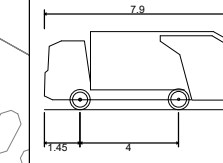
	
DB32 Refuse Vehicle	7.900m
Overall Length	2.400m
Overall Width	3.183m
Overall Body Height	0.388m
Min Body Ground Clearance	2.400m
Max Track Width	6.00s
Lock to lock time	9.625m
Kerb to Kerb Turning Radius	

NOTES

1. Dimensions in meters, unless otherwise stated.
2. This drawing should be read in conjunction with other relevant engineering details, drawings & specifications.
3. Any discrepancies should be reported to the design engineer immediately, so that clarification can be sought prior to the commencement of works.
4. The dimensions must be verified on site before construction.
5. All works are to be in accordance with Southwark borough council specification and standards.

KEY

PROPOSED ROAD MARKINGS:

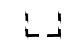
-  Proposed Double Yellow line to replace Single Yellow line
-  Proposed Permit holders bay to replace Single Yellow line

LOCATION PLAN:

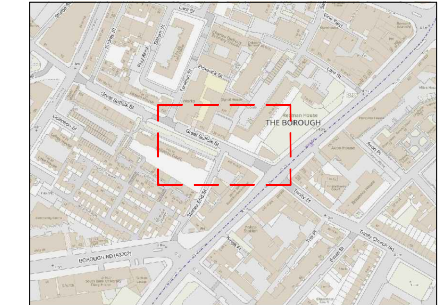

REV	DATE	REVISION DESCRIPTION / DETAILS	DRN BY	CHKD BY	APPRVD BY
-	29.08.23	OUTLINE DESIGN	BR	-	-



PROJECT: MINOR WORKS
GREAT SUFFOLK STREET J/W
STONES END STREET

TITLE: SWEPT PATH ANALYSIS

STATUS: OD	DRAWN: BR
SCALE: 1:200 @ A3	DESIGNED: BR
	CHECKED: -
	APPROVED: -

DRAWING NO: LBS/MW/GREAT_SUFFOLK_ST/SPA-01	REV: -
DATE DRAWN: 29 AUG 2023	DATE ISSUED: XXX